

SSL961 Hotel Energy Saving Switch



This modern design, hotel energy saving switch is easy to operate and can function with different cards. The unit also has a 'stand by' light, which is used to locate the unit when you enter a darkened room.

The energy saving switch can be used in hotel room's to control sockets and appliances, including the lighting.



Features & Benefits

- Up to 20-30% total energy saving
- LED indication and PC isolation material
- Ensures all of the devices shut off after the card is withdrawn
- Suitable for working with construction automation systems, energy management systems and lighting control systems
- Uses the same card, for both; opening the door and supplying power
- This product is designed and produced in accordance with CE regulations
- Blue 'stand by' light to ensure the unit can be located, even in the dark
- Ivory finish; also available in grey, silver and black to special order.

Product Operation

Insert a relevant card into the switch, then all appliances will immediately gain power. When the card is withdrawn from the switch, there will be a 10-30 second delay before all power in the room is shut off.

SSL961 Hotel Energy Saving Switch

Specifications

Installation

Open the cover plate of card key switch from driving parts box with screwdriver

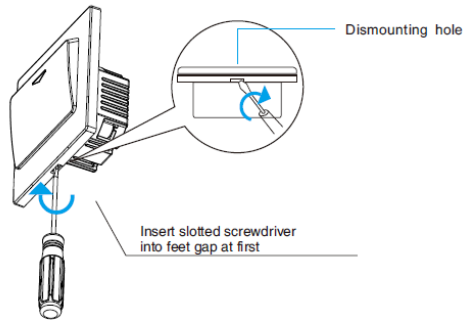

Draw out power cable from wall box and trim up, press tightly on terminal block as illustration

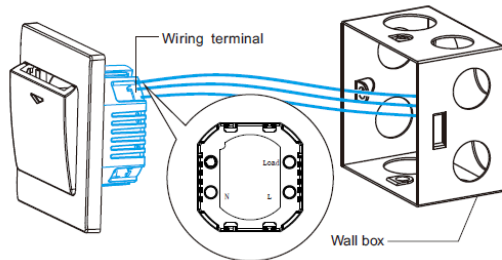

Wiring

Normal wiring

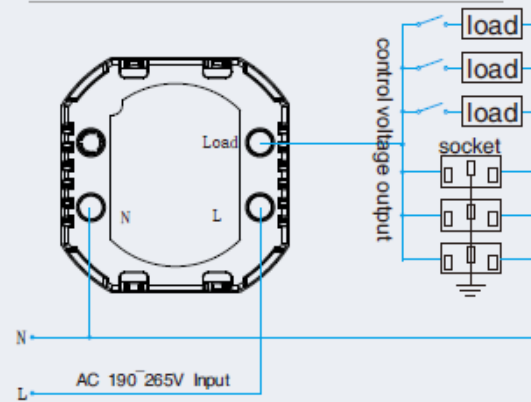

Connected with AC contactor

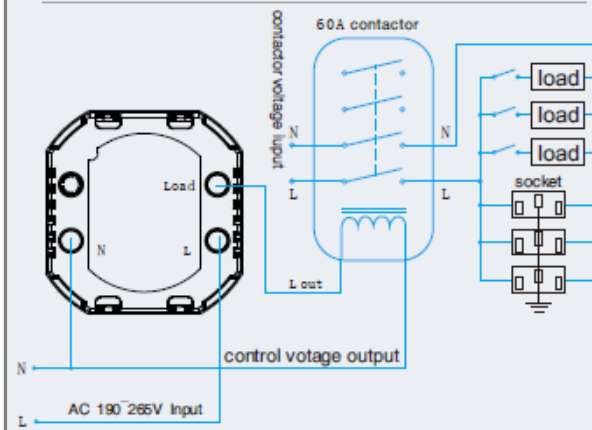

Product Details

Voltage	AC 190-365V (50-60Hz)
Egress Time Delay	10-30s
Load Current	≤16A
Service Life	100,000 time use
Operating Temperature	10°C-60°C
Operating Humidity	50°C 10-95%
Dimensions (mm)	(WxHxD) 86 x 86 x 44

For further information contact:

Securefast plc
6, The Cedars Business Centre
Avon Road, Cannock
Staffordshire
WS11 1QJ



Call > +44 (0) 1704 502 801

Email > sales@securefast.co.uk

Visit > www.securefast.co.uk