

## ASL951BW Range OnDoor Smartlock MIFARE™ Network System



**The SmartLock ASL951BW range is a wireless networked system offering all the advantages of the standalone system with the benefit of wireless networking.**

The RFID technology offers an easy to use and secure access solution ideal for medium to large installations. The system includes a battery powered door mounted lock, plus mains powered controller to control the electric locking mechanisms, lifts, barriers etc. and management software.

### Certification

Fire rated for 60 min. to EN1634-1:2014 on composite timber door.

Intertek Report No. 141222001SHJ-BP-1  
Dated 23<sup>RD</sup> Jan 2015

Certified to EN14846:2008  
Classification Code 3-S-5-1-0-J-3-1-2  
Intertek Report No. 131014059GZU-001  
Dated 14<sup>th</sup> Oct 2013

CE approved

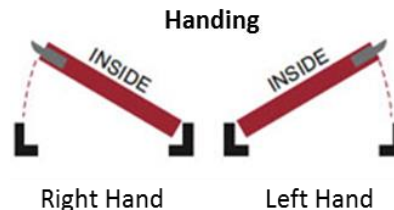

### Features & Benefits

- Lock case has 65mm backset with 93.5mm crs
- Centralised card programming using easy to use Windows based software
- Real time card cancellation and logging
- Fault and battery condition reporting
- Up to 64 locks / doors can be controlled by each base station
- Up to 10,000+ user cards per system
- Each card can be programmed with access to doors, groups and areas with time and date validity and shift control
- Base stations use either Ethernet or USB to communicate around the building with a wireless link to the locks
- Door controllers for electric locking can control 2 doors with the same authorities or read in/read out
- ISO printable or pre-printed cards, tokens ,etc.
- Cards can be used for multiple sites and multiple applications
- Can be set up remotely or on site
- Web browser version available
- Interfaces with leading brand PMS systems

### Ideal for:-

Medium to large systems such as hotels, universities, colleges and schools, offices, hospitals and residential accommodation.

Code	Description
ASL951BW-L	SmartLock Wireless Hotel Lockset with key override (Left Handed)
ASL951BW-R	SmartLock Wireless Hotel Lockset with key override (Right Handed)

The SmartLock ASL951BW range can also be used as standalone allowing you to mix and match.

## ASL951BW Range OnDoor Smartlock MIFARE™ Network System

Features & Benefits	SmartLock Wireless Hotel System ASL951BW
No hardwiring	•
Dead bolt for added security thrown on the inside by thumb turn	•
Powered by 4 standard AA batteries	•
Outside Lever Handle free when locked	•
Key override from the outside	•
Low battery indicator	•
Euro and ANSI lock case options	•
Mifare plus and Desfire ready	•
Cards can be used for multiple sites and multiple applications	•
Networking	•
Instant card cancelling	•
Real-time logging	•
Management system including reader / writer, wireless dongle and software	ASL957
Additional stations	ASL953
Single Door Controller Unit including 3 Amp PSU and reader	ASL950M1W
Two Door Controller Unit including 3 Amp PSU and reader	ASL950M2W
Cards	ASL954/1
PMS interface	ASL955
Base station for up to 64 doors – Ethernet / USB	ASL95BASE
Base station up to 64 doors -Wi-Fi	ASL95BASEW

### Features & Benefits

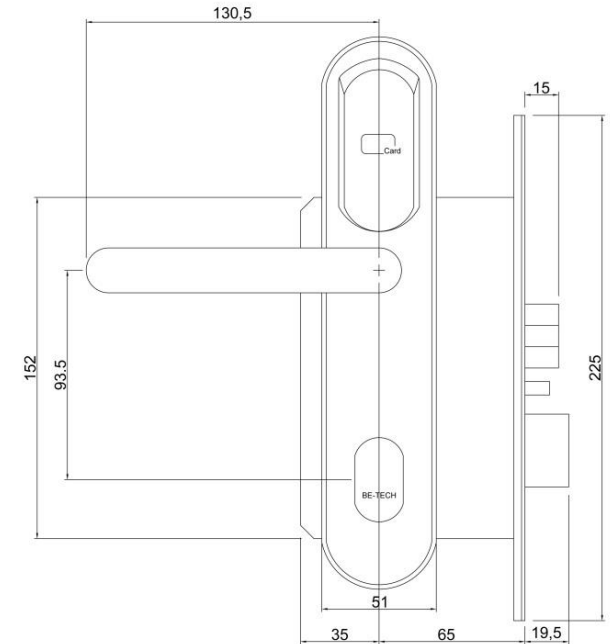

For further information contact:

**Securefast plc**  
6, The Cedars Business Centre  
Avon Road, Cannock  
Staffordshire  
WS11 1QJ



**Call** > +44 (0) 1704 502 801

**Email** > sales@securefast.co.uk

**Visit** > www.securefast.co.uk