

ADV52 Four-wire Black & White Video Entry System

The ADV52 Genway Four-wire Video Entry System has a 4" black and white monitor with telephone handset and button for lock release.

The kit also includes a flush fitting aluminium door station for the outside and a power transformer with connections. For surface mounting the door station and to offer protection from rain water a surface cover ADV52C is available.



Features & Benefits

- Four-wire connection
- Wall mounted handset with 4" black & white monitor c/w telephone handset
- Monitor has buttons for lock release and picture recall
- Monitor has indicators for power, busy and mute
- Adjustments can be made on the monitor for picture brightness, contrast and ring volume.
- Double ring tone
- Wall mounting plate for handset to conceal fixings
- Single call button and address window on door station
- Flush mounted door station, which can be surface mounted when using ADV52C Surface Cover
- Power to Unlock or Fail Secure locking devices such as the ADCN203+S Electric Release can be connected direct to the door station

ADV52 Four-wire Black & White Video Entry System

Technical Information

ADV52

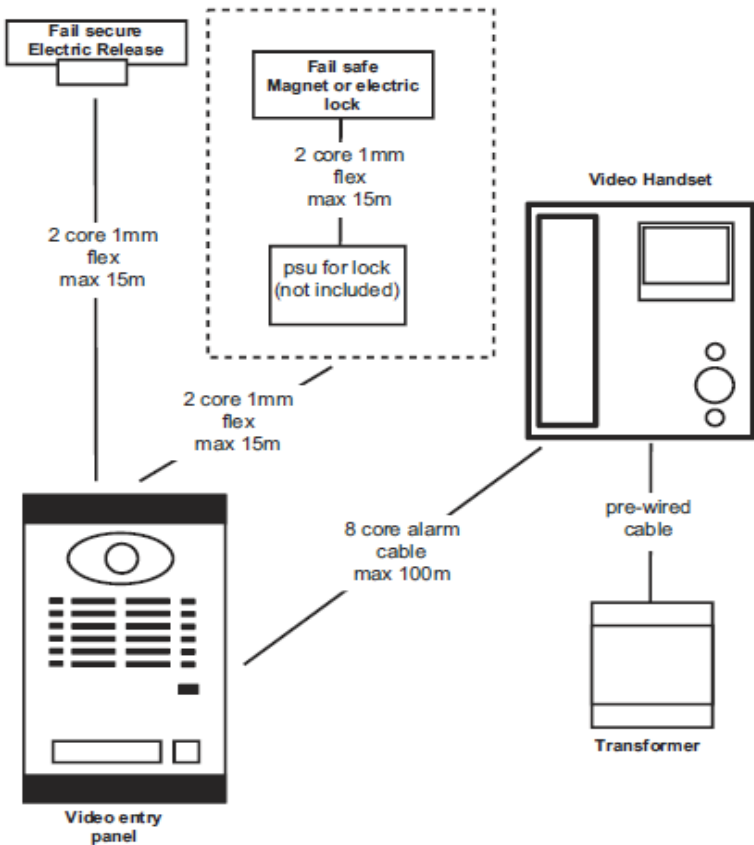

	ADV52	Handset	Door Station
Dimension		H220 x W203 x D63	H133 x W54 x D28
Weight (Kg)		1.28	0.54
Finish		White	Silver
Material		Various	Aluminium
Operating Voltage		14v DC	14v DC
Operating Current		700mA	200mA
Standby Current		100mA	30mA
Temperature		-10°C to +55°C	-40°C to +70°C
Humidity		10% to 95%	10% to 95%

For further information contact:

Securefast plc
 Unit 6 & 7
 The Cedars Business Centre
 Avon Road, Cannock
 Staffordshire
 WS11 1QJ



Call > +44 (0) 1704 502801

Email > sales@securefast.co.uk

Visit > www.securefast.co.uk